

SKD-61 STRAIGHT
EJECTOR PIN
SKD-61標準級氮化處理
單節射梢
GEPN



SKD-61 TWO STEPS
EJECTOR PIN
SKD-61氮化處理雙節
射梢
GESDS



SKD-61 RECTANGULAR
EJECTOR PIN
SKD-61標準級氮化處理
方型扁梢
GEPFA



SKH-51 STRAIGHT
EJECTOR PIN
SKH-51標準級氮節射梢
(高速鋼)
GEP5



SKH-51 TWO STEPS
EJECTOR PIN
SKH-51雙節射梢
(高速鋼)
GESS



SKH-51 HIGH PRECISION R-
ECTANGULAR EJECTOR PIN
SKH-51高精密方型扁梢
(高速鋼)
GERS



GESL FDAC EJECTOR
SLEEVE
射梢套筒
GESL



STRAIGHT CORE PINS
直式銷
GDE
GHE
GDE
GDF
GHF
GCF



EJECTOR LEADER PINS
射出導引銷
GED
GEP



TOP PROCESS STRAIGHT
CORE PINS
前端加工直式銷
GZL
GVL

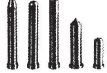

ROUND CORE PINS
一段型直式銷
(精級 ± 0.005)
GZ
GV



ROUND CORE PINS
-TAPERLESS TYPE-
無斜度一段式圓形銷
GPS
GVS

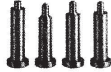

ROUND CORE PINS
-TAPERLESS TYPE-
無斜度一段式圓形銷
GPS
GVS



EJECTOR LEADER PINS
頂出導銷
GLP



EJECTOR LEADER PINS
-THROUGH BOLT HOLE-
頂出導銷
-貫穿孔式-
GLJ



PUSHER PINS
頂推銷
GBC
GBCH



DOWEL PINS
定位銷
GDP
GDPE



RUNNER LOCK PINS
止推定位銷
一般式/正規式
GRP
GRPG
GRN
GRNG



PRECISION LEADER PINS
-HEAD TYPE-
精密級導柱
-凸緣式-
GPF



PRECISION LEADER PINS
-WITH OIL GROOVE TYPE-
精密級導柱
-附油溝式-
GLN



PRECISION LEADER PINS
-LENGTH L,N SPECIFY-
精密級導柱
-長度L、N指定-
GST



PRECISION LEADER
BUSHINGS--FLANGE TYPE--
精密級襯套
-凸緣式-
GBD



PRECISION LEADER
BUSHINGS--STRAIGHT TYPE--
精密級襯套
-直式-
GBE



EJECTOR BALL BUSHING
-BALL TYPE-
導套
-配鋼珠套用-
GBF



RUBBER MOLDING TAPER
LEADER PIN SET
橡膠模定位導桿組
GT



OIL-FREE GUIDE BUSHINGS
無給油導套
—銅合金—
GPB



OIL-FREE FLANGE GUIDE BUSHINGS
無給油凸緣導套
GPF



OIL-FREE THRUST BUSHINGS
無給油止推襯套
GPFW



OIL-FREE THRUST WASHERS
無給油止推墊圈
GPW



EJECTOR RODS WITH SPRING WASHER
頂桿附彈簧華司
GRW



STOP BOLTS
停止螺栓
GSB



STRIPPER BOLTS
—MALE SCREW TYPE—
等高螺絲
GSC



PULLER BOLTS
螺牙拉桿
GSD



WASHERS
沉用型華司
皿頭型華司
GWA
GWB
GWC



SPACER RINGS
間隔墊圈
GWD
GWE
GWF



STOP RINGS
阻擋墊圈
GWG
GWH



STOP PINS
停止銷
GWI



LOCATING RINGS
定位圈
GLA
GLB
GLC
GLD
GLE



LOCATING RINGS
定位圈
GLF
GLG
GLH
GLI



SPRUE BUSHINGS
—A TYPE—
灌嘴
—A型—
GBI
GBJ



SPRUE BUSHINGS
—A TYPE—
灌嘴
—A型—
GBI
GBJ



SPRUE BUSHINGS
—B TYPE—
灌嘴
—B型—
GBK
GBL



SPRUE BUSHINGS
—B TYPE—
灌嘴
—B型—
GBM
GBN



BLOCK CORE PINS
STRAIGHT TYPE/FLANGE TYPE
方形銷
—直式凸緣式—
GHH
GHI



LOCKING BLOCKS
鎖模塊
—A, E, G指定—
GMK
GML
GMM
GMN



LOCKING BLOCKS
鎖模塊
—橫槽式—
GMO
GMP



LOCKING BLOCKS WITH ANGULAR PINS HOLE
斜孔式鎖模塊
GMR



LOCKING BLOCKS WITH ANGULAR PINS HOLE
斜孔式鎖模塊
GMS



LOCKING BLOCKS
鎖模塊(足位決定型)
—A, H, G指定—
GMT
GMU



LOCKING BLOCKS—WITH ANGULAR HOLE PROCESS
斜孔加工鎖模塊
GMV



LOCKING BLOCKS--WITH
ANGULAR HOLE PROCESS
斜孔加工鎖模塊
GMW



LOCKING BLOCKS--WITH
ANGULAR HOLE PROCESS
斜孔加工鎖模塊
GMX



SIDE COTTER BLOCKS
邊栓固定塊
—角度選擇型—
GKA



CENTER RAILS
中心滑軌
GKB



GUIDE RAILS
側開導引滑軌
GKC
GKD
GKE



OIL-FREE SLIDE PLATES
無給油耐磨滑板
GPH



OIL-FREE SLIDE PLATES
無給油耐磨板
GPP



INCLINED EJECTOR
CORE UNIT
射斜斜座
GS



SQUARE GUIDE BAR/
GUIDE RETAINER
方型導引柱/導引塊
GSBR



LOCKING BLOCK SETS
—GL TYPE—
導位固定塊
GL



LOCKING BLOCK SETS
—STRAIGHT TYPE—
導位固定塊
—直式—
GXB



LOCKING BLOCK SETS
—GLK TYPE—
導位固定塊
GLK



LOCKING BLOCK SETS
—GLM TYPE—
導位固定塊
GLM

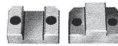

SIDE LOCKS GTL TYPE
導位固定塊
GTL



SIDE LOCKS GSL TYPE
導位固定塊
GSL



STRAIGHT BLOCK SET
—GPL TYPE—
導位固定塊
GPL



TAPER BLOCKSET-GTBS
TYPE
導位輔助器
GTBS



TAPER BLOCK SET-GTBL
TYPE
導位輔助器
GTBL



TAPER PIN SETS
導柱輔助器
(圓柱型)
GTPNV



PARTING LOCKS
樹脂開閉器
GPLA



SLIDE LOCK
開閉器半圓型
GSLA



SLIDE LOCK (SL TYPE)
開閉器SL型
GSL



SLIDE LOCK (B TYPE)
開閉器B型
GSLBS
GSLBL



SLIDE LOCK (E TYPE)
開閉器E型
GSLES
GSLEL



SLIDE LOCK (GBLS TYPE)
開閉器GBLS型(扣模器)
GBLS



SLIDE LOCK SETS
開閉器
GRLA
GRLB



DATE MARKED PINS
日期章
GDA



BALL PLUNGERS
定位珠(定位螺絲)
GBP
GBPJ



HEATSINK
冷却棒(熱管)
GH



SPIRAL BAFFLE BOARDS
冷却螺旋水套
GCA
GCB
GCT



COOLING CIRCUIT PLUGS
可移動水柱塞
GCCP



GASVENT
排氣栓
GAS



AIR POPPET VALVES
空氣銷
GVA



AIR-JET VALVES
氣動頂針(空氣銷)
GAJV



TENSION LINKS
...FLAT TYPE...
引張板
平式
GTA
GTB



TENSION LINKS
...STROKE ADJUSTABLE TYPE...
引張板
行程調整式
GTC
GTD



GUIDE PILLAR
導柱
GPHA



GUIDE PILLAR
導柱
GPHB



GUIDE PILLAR
導柱
GPHC



GUIDE BUSH
導套
GBHA



GUIDE BUSH
導套
GBHB



GUIDE BUSH
導套
GBHC



HEAVY LOAD
重荷重
TH



SUPER LOAD
極重荷重
TB



WIRE SPRINGS
圓線彈簧
LR
MR



HEAT-PROOF SPRING
塑膠模用耐熱彈簧
TR



HEAT-PROOF SPRING
塑膠模用耐熱彈簧
TY



LIGHTEST LOAD
輕小荷重
TF



LIGHT LOAD
輕荷重
TL



MEDIUM LOAD
中荷重
TM



SKD-61 STANDARD TYPE NITRIDING TREATMENT STRAIGHT EJECTOR PIN
SKD-61 標準級氮化處理單節射梢 GEPN 型

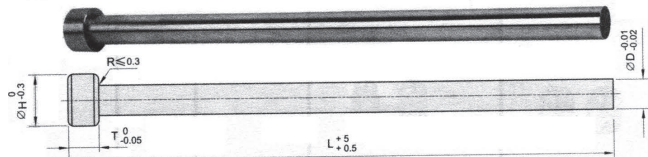

Order: Type - D - L - QTY
 GEPN - $\phi 5.5$ - 450 -

材質 SKD61
 硬度 HRC40~45
 表面硬度 HV900以上

SKD-61 NITRIDING TREATMENT TWO STEPS EJECTOR PIN
SKD-61 氮化處理雙節射梢 GESDS 型

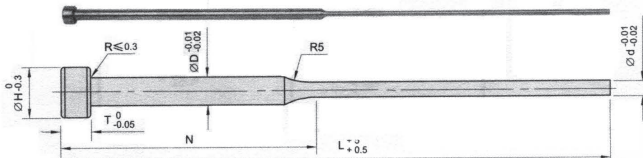

Order: Type - D - d - N - L - QTY
 GESDS - $\phi 3.0$ - $\phi 1.2$ - 50 - 150 -

材質 SKD61
 硬度 HRC40~45
 表面硬度 HV900以上

SKD-61 STANDARD NITRIDING TREATMENT RECTANGULAR EJECTOR PIN
SKD-61 標準級氮化處理方型扁梢 GEPFA 型

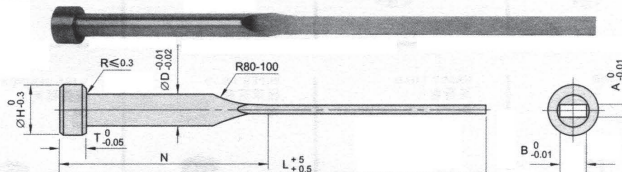

Order: Type - D - A - B - N - L - QTY
 GEPFA - $\phi 8$ - 2.0 - 7.5 - 50 - 200 -

材質 SKD61
 硬度 HRC40~45
 表面硬度 HV900以上

SKH-51 STANDARD STRAIGHT EJECTOR PIN
SKH-51 標準級單節射梢 (高速鋼) GEPS 型

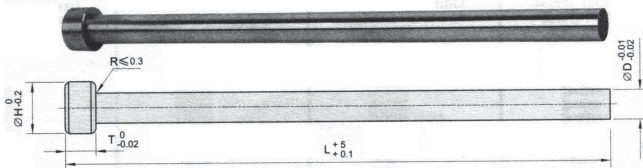

Order: Type - D - L - QTY
 GEPS - $\phi 3$ - 200 -

材質 SKH51
 硬度 HRC59~61

SKH-51 TWO STEPS EJECTOR PIN SKH-51 雙節射梢 (高速鋼) GESS 型

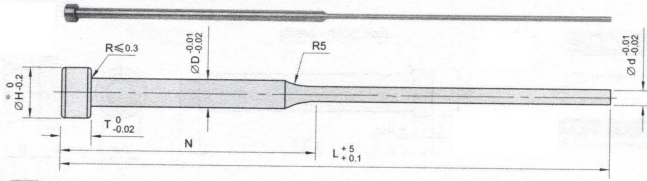

Order: Type - D - d - N - L - QTY
GESS - $\phi 3$ - $\phi 1.2$ - 50 - 150 -

材質 SKH51
硬度 HRC59-61

SKH-51 HIGH PRECISION RECTANGULAR EJECTOR PIN SKH-51 高精型方型扁梢 (高速鋼) GERS 型

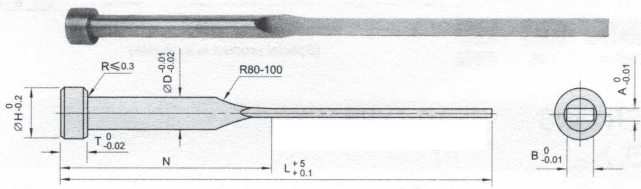

Order: Type - D - A - B - N - L - QTY
GERS - $\phi 8$ - 2 - 7.5 - 50 - 200 -

材質 SKH51
硬度 HRC59-61

GEST FDAC EJECTOR SLEEVE 射梢套筒

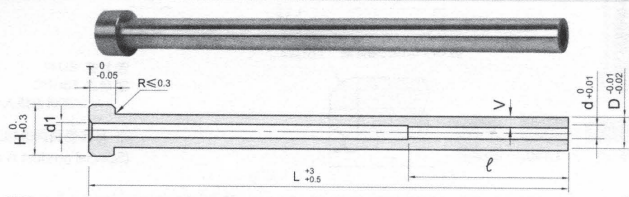

Order: Type - D - d - L - QTY
GESL - $\phi 6$ - $\phi 2.5$ - 150 -

材質 FDAC
硬度 氮化處理 HV900~1100°
真空處理 HRC52±2°

DOWEL PINS 定位銷

GDP

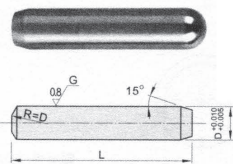

Order: Type No. - L - QTY
GDP 5 - L20 -

材質 SUJ2
硬度 58HRC

GDPE(附螺牙精密型)

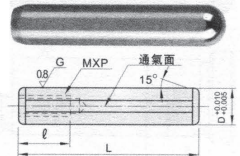

Order: Type No. - L - QTY
GDPE 5 - L20 -

材質 SUJ2
硬度 58HRC

※ 可接受圖面追加工
(Special product is available)

RUNNER LOCK PINS

止推定位銷 (一般式/正規式)

Type No.	材質	硬度
GRP	SKH51	61~64HRC
GRPG		



一般式

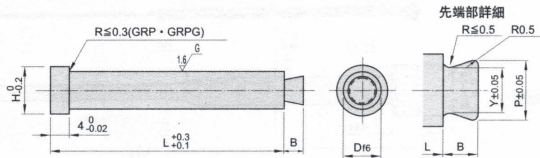

Type No.	材質	硬度
GRN	SKH51	61~64HRC
GRNG		



正規式

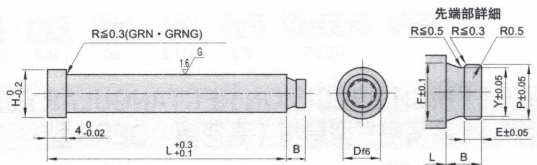

Order: Type No. - L - QTY
GRP 4 - L35 -

※ 可接受圖面追加加工
(Special product is available)

PRECISION LEADER PINS HEAD TYPE

精密級導柱 (凸緣式)

GPF

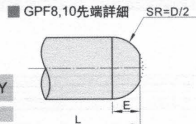
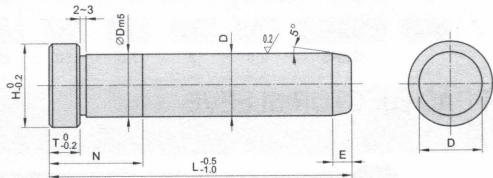

Order: Type No. - L - QTY
GPF 20 - L140 -

材質 SUJ2
硬度 58HRC
(高週波焼入)

※ 可接受圖面追加加工
(Special product is available)

PRECISION LEADER PINS WITH OIL GROOVE TYPE

精密級導柱 (附油溝式)

GLN

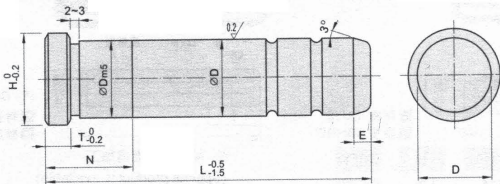
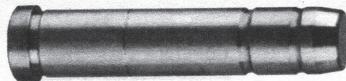

材質 SUJ2
硬度 58HRC
(高週波焼入)

STRIPPER BOLTS MALE SCREW TYPE 等高螺絲

GSC

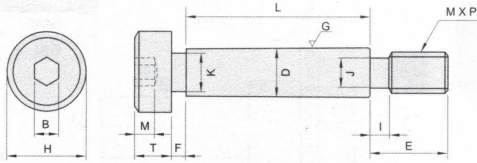

Order: Type No. - L - QTY
GSC 8 - L45 -

材質 SCM435

LOCATING RINGS 定位圈

GLA

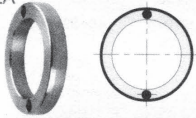

GLB

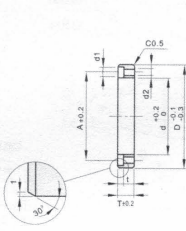
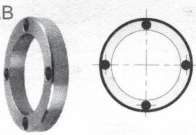

材質 S45C

GLE

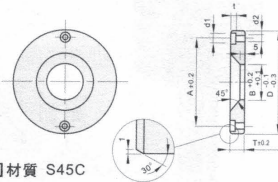

材質 S45C

Order: Type No. - T - B - QTY

GLA 100 - T15 -

GLE 100 - T15 - B35 -

※ 可接受圖面追加工 (Special product is available)

SPRUE BUSHINGS 灌嘴 (A型)



Type No.	材質	硬度
GBG	S45C	
GBH	SKD61	48-52HRC

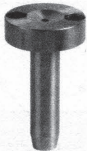
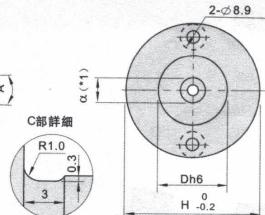
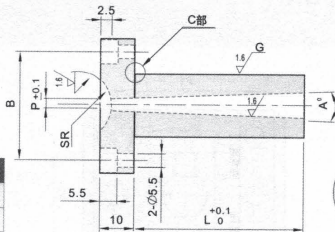

Type No.	材質	硬度
GBI	S45C	
GBJ	SKD61	48-52HRC

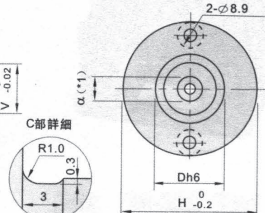
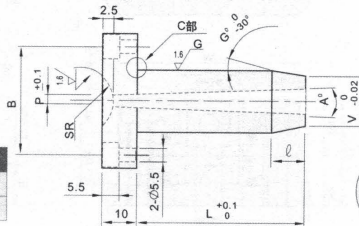

Order: Type No. - L - SR - P - A - V - G - QTY
GBG 10 - L82.5 - SR11 - P3 - A2 - V6.0 - G5 -

SPRUE BUSHINGS

灌嘴 (B型)

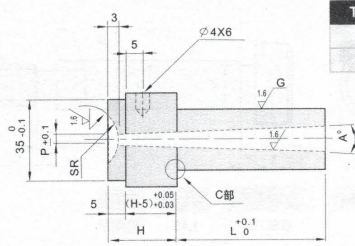
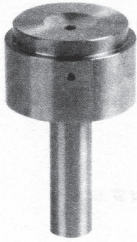

Type No.	材質	硬度
GBK	S45C	—
GBL	SKD61	48~52HRC

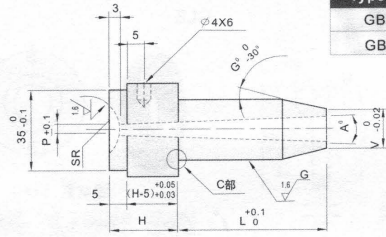
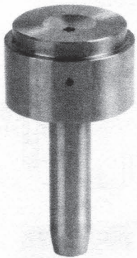
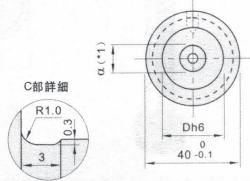

Type No.	材質	硬度
GBM	S45C	—
GBN	SKD61	48~52HRC

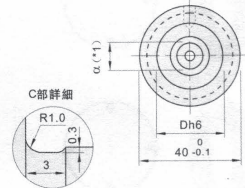

Order: Type No. - H - L - SR - P - A - V - G - QTY
 GBM 20 - H25 - L60.0 - SR11 - P3.5 - A3 - V16.0 - G5 -

INCLINED EJECTOR CORE UNIT

射銷斜座

GS

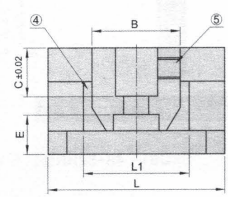
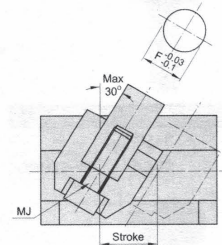
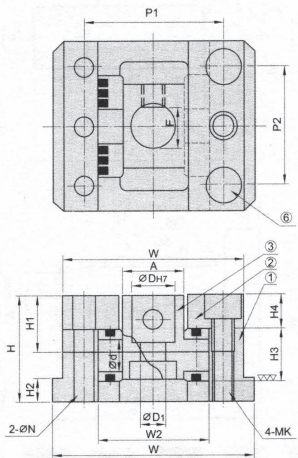
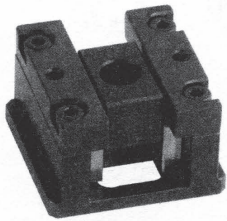

Order: Type No. - QTY
 GS 25 -

LOCKING BLOCK SETS STRAIGHT TYPE 導位固定塊 (直式)

GXB

使用例

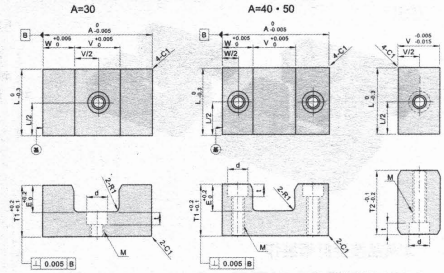
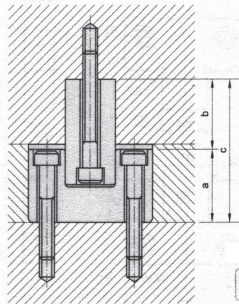
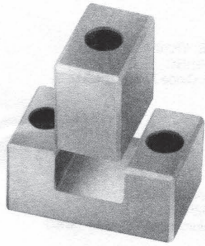

Order:

Type No.

T1

QTY

GXB 40

19

- ① 材質 YK30
- 硬度 56-60HRC
- ② 材質 SKD11
- 硬度 58-62HRC

LOCKING BLOCK SETS GLK TYPE 導位固定塊

GLK

使用例

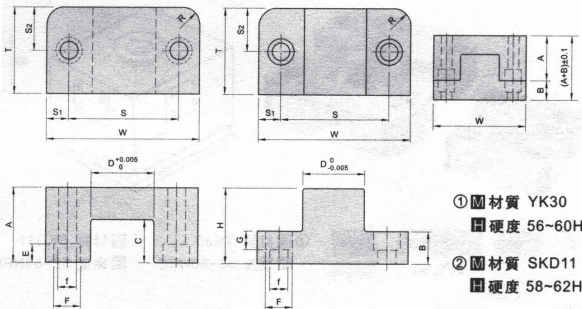
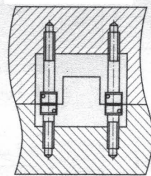
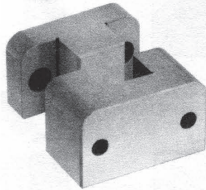

Order:

Type No.

QTY

GLK 15

- ① 材質 YK30
- 硬度 56-60HRC
- ② 材質 SKD11
- 硬度 58-62HRC

SIDE LOCKS GLK TYPE 導位固定塊

GTL

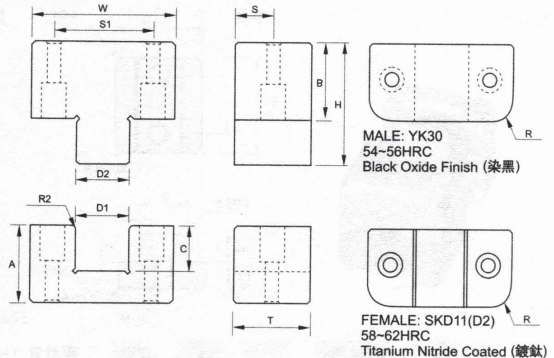
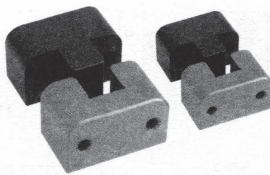

本產品接受訂購製作



Order:

Type No.

QTY

GTL 150

MALE: YK30
54-56HRC
Black Oxide Finish (染黑)

FEMALE: SKD11(D2)
58-62HRC
Titanium Nitride Coated (鍍鈦)

SIDE LOCKS GSL TYPE 導位固定塊

GSL

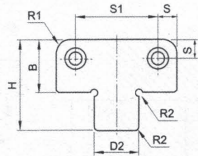
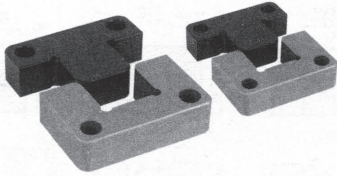

MALE: YK30
54~56HRC
Black Oxide Finish (染黒)

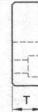
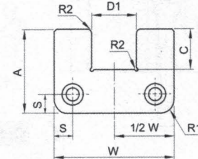

FEMALE: SKD11(D2)
58~62HRC
Titanium Nitride Coated (鍍鈦)

本產品接受訂購製作

Order: Type No. - QTY
GSL 50 -

STRAIGHT BLOCK SET-GPL TYPE 導位固定塊

GPL

使用例

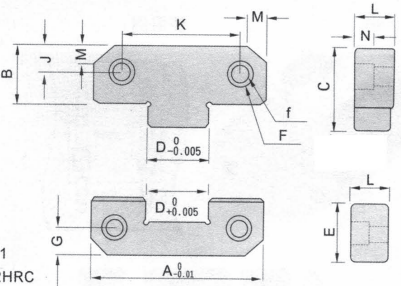
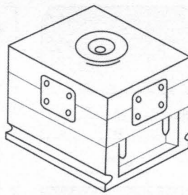
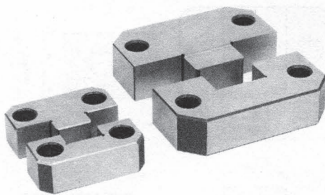

Order: Type No. - QTY
GPL 50 -

① 材質 YK30 ② 材質 SKD11
■ 硬度 56~60HRC ■ 硬度 58~62HRC

TAPER BLOCK SET-GTBS TYPE / TAPER BLOCK SET-GTBL TYPE 導位輔助器

GTBS

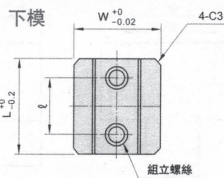
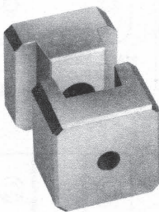

上模

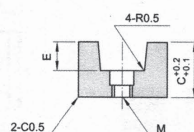
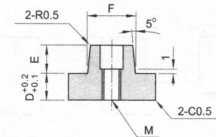
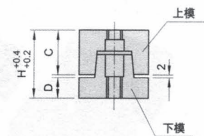
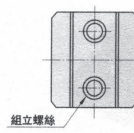

使用例

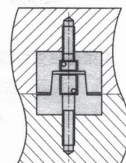

Order: Type No. - W - L - QTY
GTBS - 25 - 30 -

■ 材質 YK30 ■ 硬度 56~60HRC

TAPER BLOCK SET-GTBS TYPE / TAPER BLOCK SET-GTBL TYPE 導位輔助器

GTBL

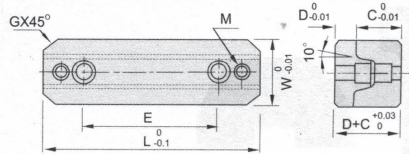
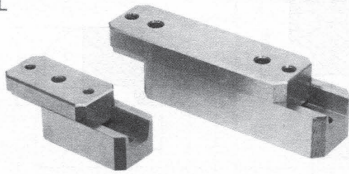

Order: Type No. QTY
GTBL 50

材質: S50C
硬度: 52-56HRC

TAPER PIN SETS 導柱輔助器 (圓柱型)

GTPNV

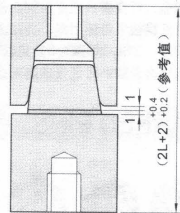
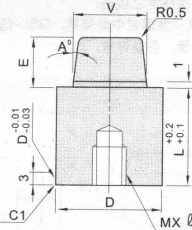
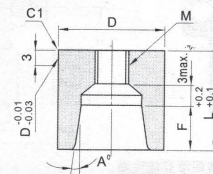
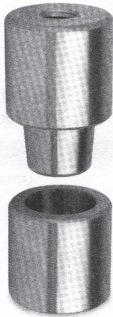

Order: Type No. QTY
GTPNV 20

材質: SUJ2 硬度: 55-60HRC

PARTING LOCKS 樹脂開閉器

GPLA

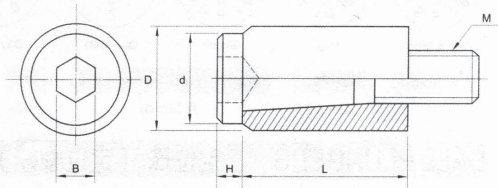
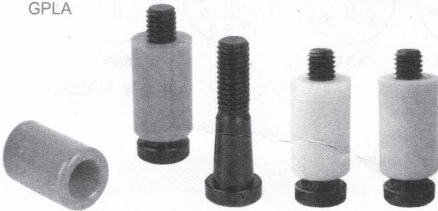

材質 ①SCM435 ②樹脂

Order: Type No. D QTY
GPLA - ØD12

《樹脂開閉器》特性說明:

1. 由斜度螺絲調整模板與樹脂間之摩擦力, 約轉1/4圈可合閉模具約5萬次。
2. 模具裝置卸容易、簡單、價格低。
3. 此裝置也可用在小水口板與打中板或二段頂出小水口或滑座之工件上。
4. 模具重量100Kg以下用12個-4個, 500Kg以下用16個-4個, 1000Kg以下用20個-4個, 若超過1000Kg以上, 則增加為6個以上。
5. 樹脂埋入公模板約3公分, 母模之孔以H7之紋刀加工至+0.1mm範圍內內面加工至▽▽▽-▽▽▽▽
6. 母模面請加工成R狀。如做C面之倒角, 耐久性較差。
7. 請勿在樹脂上加油, 因為加油會使摩擦力減低。

分: 白 黃 橘 三色

SLIDE LOCK 開閉器半圓型 / 開閉器SL型

GSLA 半圓型

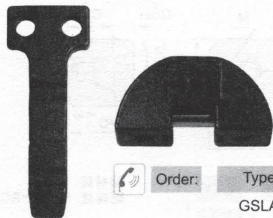

Order: Type - QTY
GSLA -

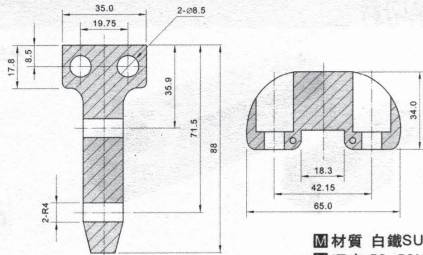

材質 白鐵SUS404
硬度 50-52HRC

SL型

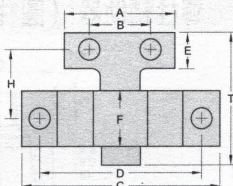

材質 SCM21
硬度 55-60HRC

裝置之功能及優點:

1. 利用簡單之構造, 可使模具完全打開與密合, 且裝置簡單互換性高。
2. 本裝置最適合三板板之針點射出, 有拉斷料頭與脫模一次完全之功能。
3. 本裝置有四種型: GSL-2型適合5盎司以下之模具, GSL-3型適合中型模具, GSL-4型適合大型模具。
4. 本裝置採用高級合金鋼熱處理後研磨而成, 採用進口彈簧, 品質可靠。

Order: Type No. - QTY
GSL4S -

DATE MARKED PINS 日期章

GDA

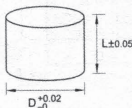
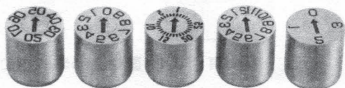

D	4	5	6	8	10	12	16	20	30
L	6	8	8	10	10	12	14	14	25



Year & Month



Year



Month



Day (0-3)



Day (0-9)



ABC



A-L



Blank

Order: Type No. - 刻印文字 (Engraving Characters) - QTY
GDA 12 - 月 Month -

材質 SUS420

BALL PLUNGERS 定位珠 (定位螺絲)



Order: Type No. - QTY
GBP-6 -
GBPJ-4 -

※定位珠, 有一字型及內六角型供選擇。

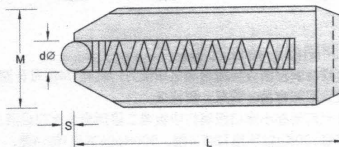

材質 SCM21
鋼珠 SUJ2